

## GESCHAKELDE VOEDING SINGLE OUTPUT 36W 12V/3A

€ 20,95

Excl. BTW: € 17,31

### Afbeeldingen

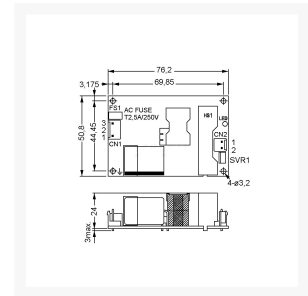
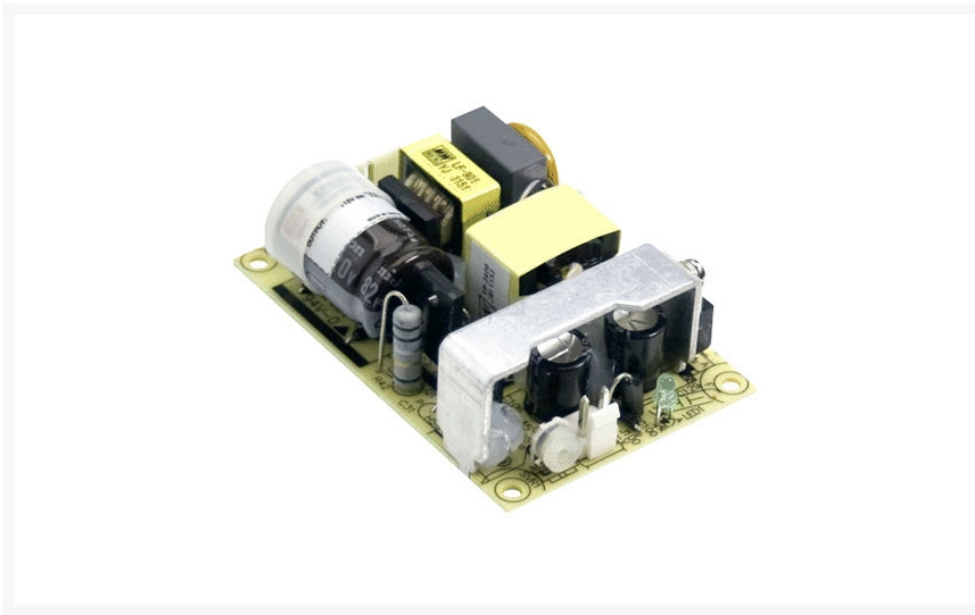

### Beschrijving

#### Features

- Open frame
- Compact case, 3" x 2"
- Contact pin for nylon-crimp terminals
- Universal input
- Overload protection, pulsing hiccup shutdown, auto recovery
- Protections: short circuit/over load/over voltage
- Low no load power consumption

#### Technical Specifications

Input Voltage:

85...264V AC (47...63Hz)

120...370V DC

Input Inrush Current, Max.:	40A
Leakage Current, Max.:	1mA
Over Load Protection:	115...170%
Withstand Voltage	
I/P-O/P:	3000V AC
I/P-FG:	2000V AC
O/P-FG:	500V AC
Operating Temperature:	-30...+70°C
Weight:	85g

I/P = Input, O/P = Output, FG = Frame Ground

Part Nr.	$U_A$	$I_A$	$P_A$	$DU_A$	$U_{RN}$	h
	[V]	[A]	[W]	[%]	[mV <sub>p-p</sub> ]	[%]
EPS-35-3.3	3,3	0...6,6	19,8	2,5	60	80
EPS-35-5	5	0...6,6	30	2	70	82
EPS-35-7.5	7,5	0...5,2	35,25	2	80	84
EPS-35-12	12	0...3,3	36	1	100	87
EPS-35-15	15	0...2,65	36	1	100	88
EPS-35-24	24	0...1,65	36	1	180	89
EPS-35-27	27	0...1,45	35,1	1	180	89
EPS-35-36	36	0...1,1	36	1	200	89
EPS-35-48	48	0...0,82	36	1	240	90

$U_A$  = Output Voltage,  $I_A$  = Output Current Range,  $P_A$  = Output Power,  $DU_A$  = Output Voltage Tolerance,  $U_{RN}$  = Ripple & Noise, h = Efficiency

#### Note

These power supplies are considered as a component that has to be installed in a final equipment.

## Productinformatie

---

Artikelnummer	EPS3512
Merk	MEANWELL

